

IX (世界測地系) 埼玉県川口市境界確定図

栄町一丁目
8
(4/4)
0021080

栄町一丁目
7
(3/3)
0021070

栄町一丁目
6
(1/2)
0021060

栄町一丁目
5
(1/2)
0021050

栄町一丁目
19
(1/4)
0021190

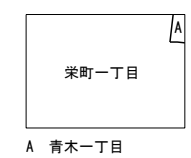
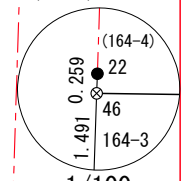
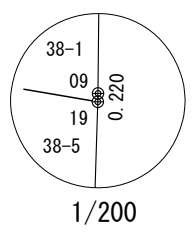
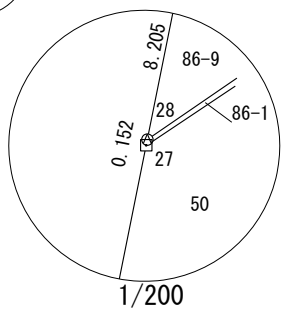
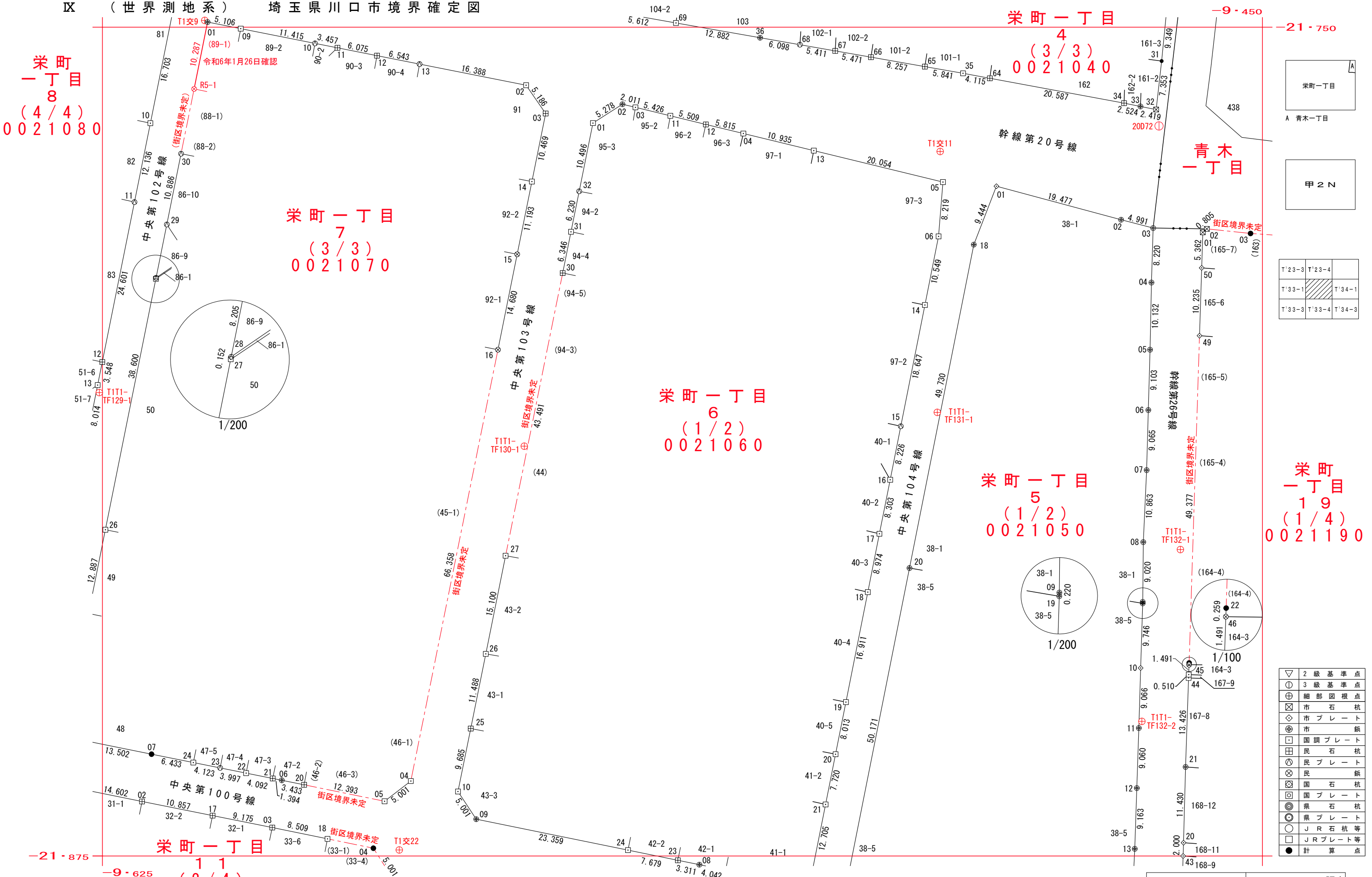

T'23-3	T'23-4
T'33-1	T'34-1
T'33-3	T'33-4
	T'34-3

▽	2級基準点
⊙	3級基準点
⊕	細部図根点
⊗	市石杭
◇	市プレート
⊕	市鉄
⊕	国調プレート
⊕	民石杭
⊕	民プレート
⊕	民鉄
⊕	国石杭
⊕	国プレート
⊕	県石杭
⊕	県プレート
⊕	JR石杭等
⊕	JRプレート等
●	計算点

※街区境界調査が完了した後に確定した筆は、確認日を記入し、赤実線・赤文字・街区境界未定に()付けで表記する。

川 T'33-2	2022. 12 調査
1 : 500	2023. 1 測図

座標一覧表

点名	X座標	Y座標
0021040		
0021040-31	-21755.116	-9465.213
0021040-32	-21762.423	-9466.039
0021040-33	-21761.958	-9468.413
0021040-34	-21761.461	-9470.888
0021040-35	-21756.960	-9495.178
0021040-36	-21751.594	-9525.792
0021040-64	-21757.710	-9491.131
0021040-65	-21755.951	-9500.932
0021040-66	-21754.526	-9509.066
0021040-67	-21753.581	-9514.455
0021040-68	-21752.647	-9519.785
0021040-69	-21749.363	-9538.480
0021060		
0021060-01	-21764.464	-9551.005
0021060-02	-21761.626	-9546.554
0021060-03	-21762.094	-9544.598
0021060-04	-21766.040	-9528.318
0021060-05	-21773.358	-9498.205
0021060-06	-21781.551	-9498.865
0021060-08	-21876.300	-9534.952
0021060-09	-21869.445	-9568.612
0021060-10	-21865.269	-9571.365
0021060-11	-21763.372	-9539.324
0021060-12	-21764.670	-9533.970
0021060-13	-21768.622	-9517.692
0021060-14	-21791.898	-9500.924
0021060-15	-21810.187	-9504.563
0021060-16	-21818.255	-9506.168
0021060-17	-21826.399	-9507.789
0021060-18	-21835.201	-9509.541
0021060-19	-21851.787	-9512.841
0021060-20	-21859.646	-9514.405
0021060-21	-21867.218	-9515.912
0021060-23	-21875.639	-9538.197
0021060-24	-21874.107	-9545.722
0021060-25	-21855.775	-9569.447
0021060-26	-21844.514	-9567.173
0021060-27	-21829.712	-9564.184
0021060-30	-21787.081	-9555.573
0021060-31	-21780.860	-9554.317
0021060-32	-21774.753	-9553.083

令和6年1月26日確認

点名	X座標	Y座標
0021070		
0021070-R5-1	-21759.320	-9611.173

座標一覧表

点名	X座標	Y座標
0021050		
0021050-01	-21773.991	-9490.136
0021050-02	-21779.044	-9471.325
0021050-03	-21780.297	-9466.493
0021050-04	-21788.514	-9466.749
0021050-05	-21798.644	-9466.954
0021050-06	-21807.744	-9467.220
0021050-07	-21816.806	-9467.476
0021050-08	-21827.658	-9467.983
0021050-09	-21836.678	-9468.066
0021050-10	-21846.640	-9468.381
0021050-11	-21855.702	-9468.655
0021050-12	-21864.757	-9468.956
0021050-13	-21873.915	-9469.272
0021050-18	-21782.797	-9493.551
0021050-19	-21836.898	-9468.073
0021050-20	-21831.572	-9503.254
0021070		
0021070-01	-21749.235	-9609.143
0021070-02	-21758.754	-9561.089
0021070-03	-21763.022	-9558.142
0021070-04	-21863.691	-9578.474
0021070-05	-21866.739	-9582.440
0021070-06	-21863.574	-9597.947
0021070-07	-21859.640	-9617.598
0021070-09	-21750.227	-9604.134
0021070-10	-21752.445	-9592.936
0021070-11	-21753.117	-9589.544
0021070-12	-21754.298	-9583.584
0021070-13	-21755.569	-9577.165
0021070-14	-21773.284	-9560.214
0021070-15	-21784.256	-9562.430
0021070-16	-21798.646	-9565.337
0021070-20	-21864.261	-9594.583
0021070-21	-21863.300	-9599.314
0021070-22	-21862.497	-9603.327
0021070-23	-21861.712	-9607.247
0021070-24	-21860.903	-9611.290
0021070-26	-21825.790	-9624.556
0021070-27	-21787.949	-9616.937
0021070-28	-21787.799	-9616.907
0021070-29	-21779.755	-9615.288
0021070-30	-21769.083	-9613.139

座標一覧表

点名	X座標	Y座標
0021080		
0021080-10	-21764.481	-9617.773
0021080-11	-21776.379	-9620.168
0021080-12	-21800.496	-9625.024
0021080-13	-21803.975	-9625.724
0021110		
0021110-02	-21866.773	-9619.030
0021110-03	-21870.706	-9599.387
0021110-04	-21873.821	-9584.125
0021110-17	-21868.905	-9608.384
0021110-18	-21872.408	-9591.049
0021190		
0021190-01	-21780.944	-9459.007
0021190-02	-21780.424	-9458.392
0021190-03	-21781.111	-9451.799
0021190-20	-21872.993	-9461.910
0021190-21	-21861.566	-9461.608
0021190-22	-21845.887	-9461.067
0021190-43	-21874.993	-9461.973
0021190-44	-21848.147	-9461.145
0021190-45	-21847.637	-9461.127
0021190-46	-21846.146	-9461.076
0021190-49	-21796.534	-9459.502
0021190-50	-21786.304	-9459.177

座標一覧表

点名	X座標	Y座標
基準点座標		
20D72	-21764.902	-9465.613
T1T1-TF129-1	-21805.108	-9625.476
T1T1-TF130-1	-21813.188	-9561.362
T1T1-TF131-1	-21808.095	-9499.062
T1T1-TF132-1	-21828.783	-9462.379
T1T1-TF132-2	-21854.690	-9468.201
T1交9	-21748.979	-9609.569
T1交11	-21768.754	-9498.626
T1交22	-21874.084	-9580.226

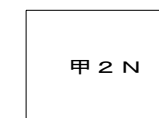

T'23-3	T'23-4	
T'33-1		T'34-1
T'33-3	T'33-4	T'34-3